

UNIVERSAL FURNITURE

ITEM NUMBER- U365690

ITEM DESCRIPTION- MILO BAR CABINET

Assembly Instructions

1-2 Person required for Shelf Assembly.

PART ENCLOSED:

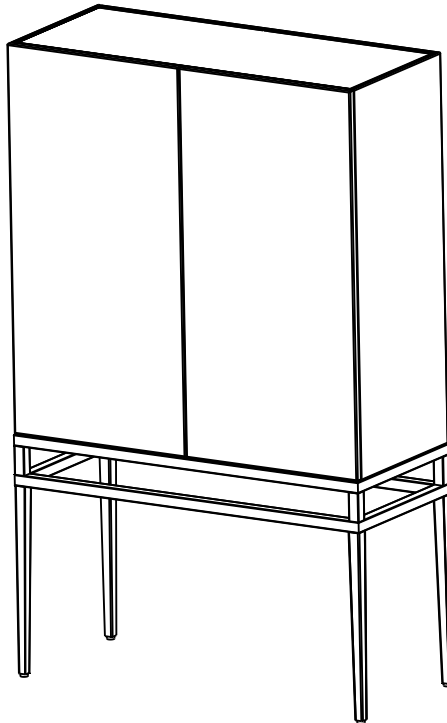

MILO BAR CABINET (x1)

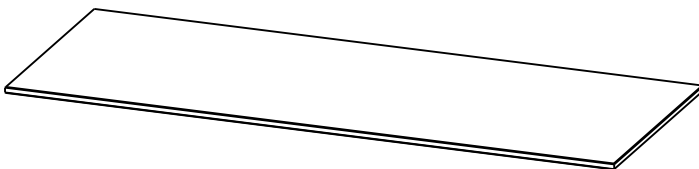

GLASS SHELF (x2)

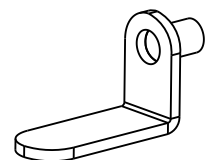

SHELF HOLDER (x8)

UNIVERSAL FURNITURE

Step-1.

NOTE- Push the right door at top to open.

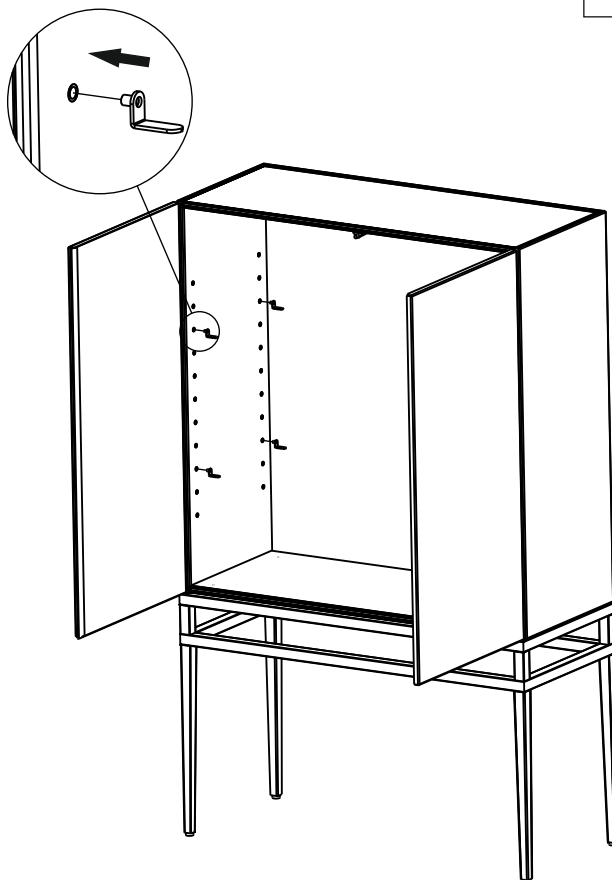

Step-2.

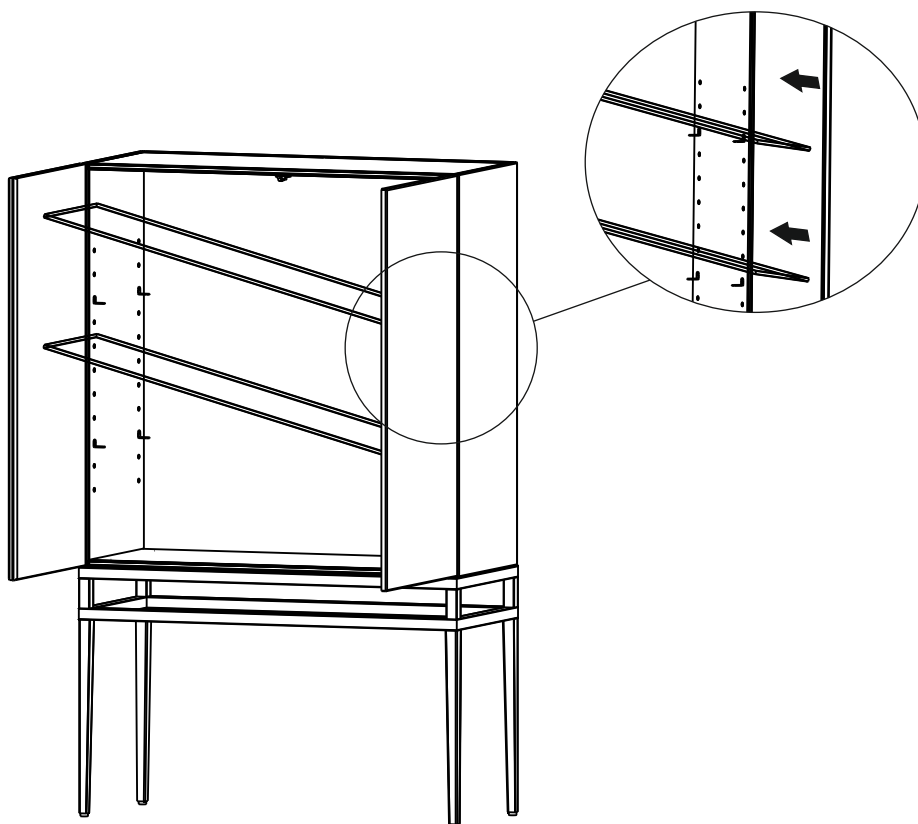

UNIVERSAL FURNITURE

Step-3.



Step-4.

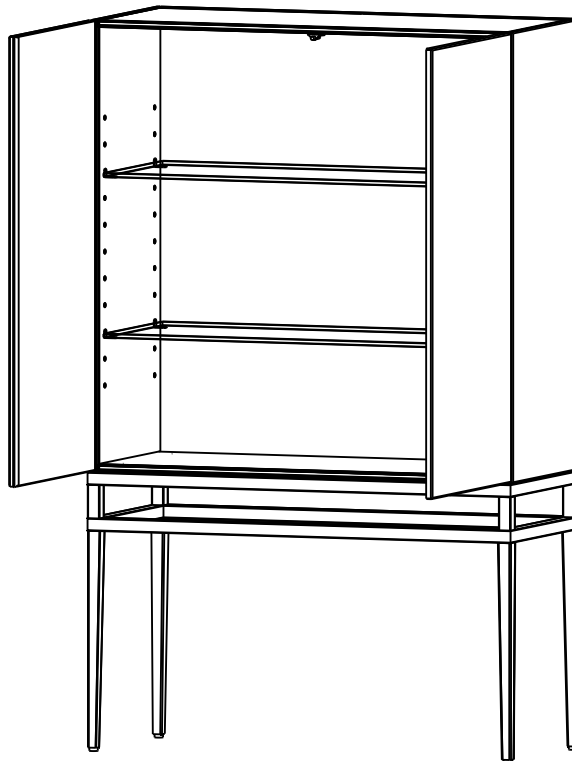

Care Instructions-

Clean with soft, dry cloth. Do not use any abrasive cleaners.
Wipe off spills immediately.

UNIVERSAL FURNITURE

ANTI TIP KIT INSTRUCTIONS



Brackets
2 Pieces



Small screw
2 Pieces



Long screw
2 Pieces



Wire Strap
1 Piece



Rivet
2 Pieces



Pin
2 Pieces

1. Using the short screw attach one of the brackets towards one side of the rear of the furniture frame below the level of the top.

2. Move the furniture into its final position to measure and mark location to attached the second bracket to the wall. Then move the furniture out the way so that the bracket can then be mounted to the wall.

3. Attach the brackets to the marked locations on the wall with long screws.

4. Move the furniture into its final position. Lock the wire strap through the bracket with the given Rivet Pin.

